

# HALL -1A

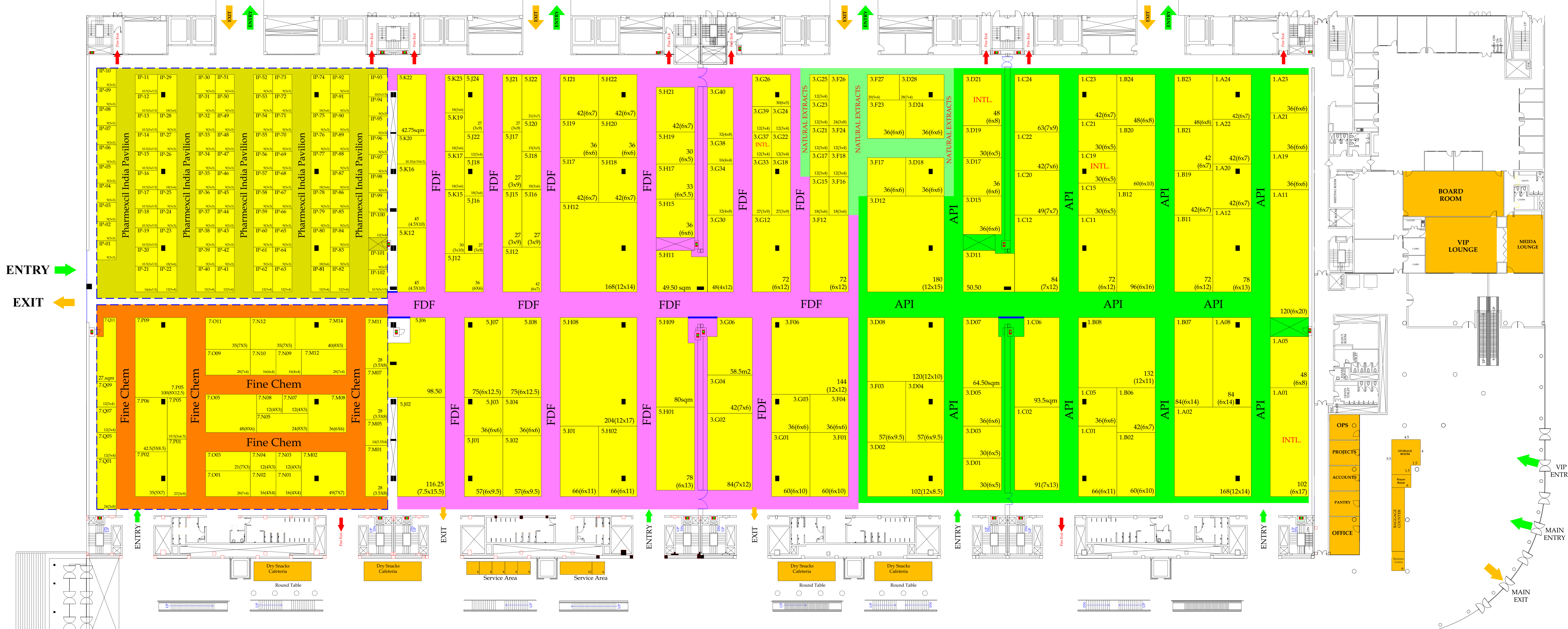
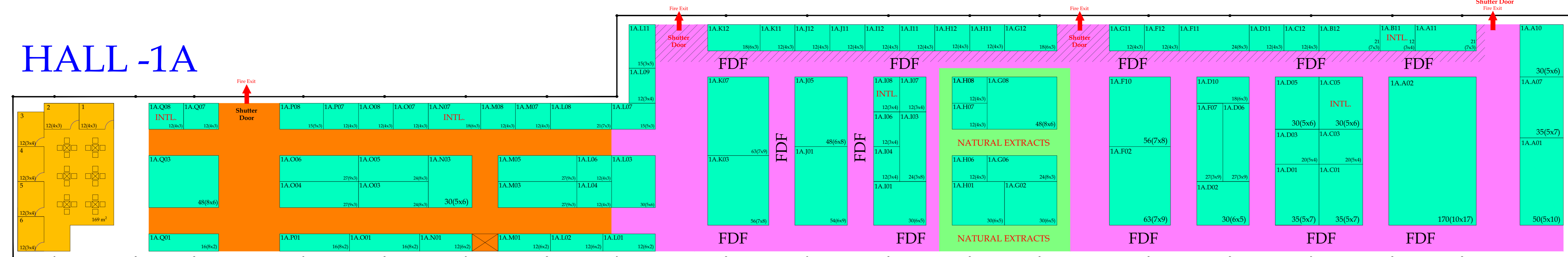

HALL -7

HALL -5

HALL -3

HALL -1

EVENT HALL: HALLS 1,1A, 2, 3, 4, 5, 6, 7 & 8

EVENT DATE: 26 -28 NOVEMBER 2024

VENUE: IEML, GREATER NOIDA

Pillar Size  
Hall 1-8 : 0.60 x 0.80  
Hall 2 : 0.80 x 1.00

Platinum
Gold
Silver

**Rules & Regulations**

- Booths below 27 m<sup>2</sup> are compulsory shell scheme booth. No wooden fabrication / modification allowed.
- Common wall height restricted to 2.5 m.
- Maximum height allowed for bare space booth - 4 m.
- Maximum height allowed for modified shell scheme - 3.5 m.
- "Please ensure to use pre-fabricated structures to avoid over-crowding on site thus creating a safer, healthier working environment for the benefit of all, hence any kind of construction on site will not be allowed. Only fixing and touchups will be allowed."
- Contribute towards sustainability by reusing booth materials.

Hall No. 1 & 3 - 1.5 TONNE/m<sup>2</sup> only. Hall No. 2,4,5 & 7 - 750 TONNE/m<sup>2</sup> only. HALL 6 & 8 - 500 Kgs/m<sup>2</sup> only.

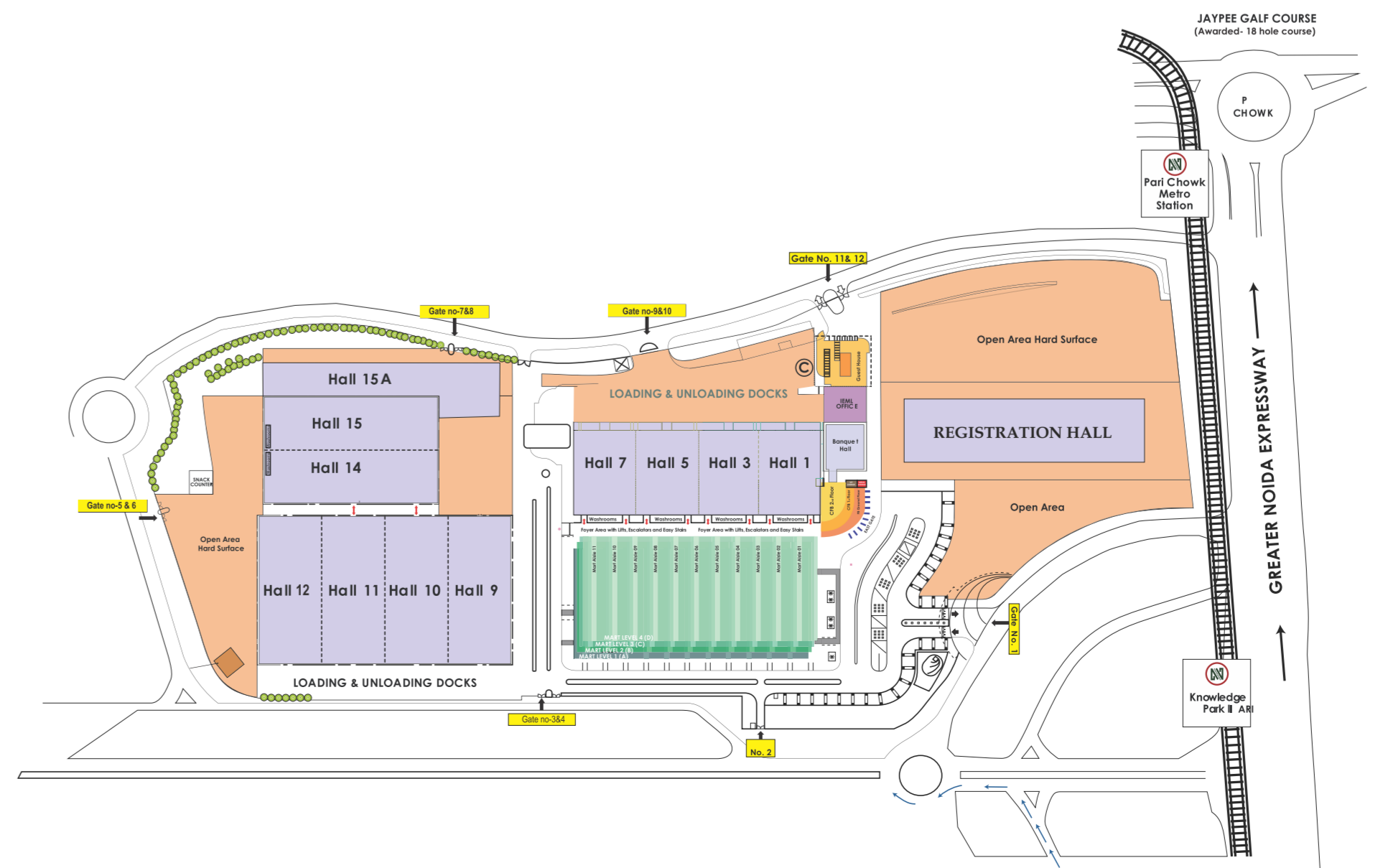

**CPHI**  
India

**informa**  
markets  
Informa Markets India Pvt Ltd